



ANDERSON TOWNSHIP PUBLIC SAFETY SERVICES

Thursday, June 20, 2024

Anderson Township Board of Township Trustees

Public Safety Levy Funded Operations

What is funded by Anderson's Public Safety Levy?

Anderson Township...



Employs **72 full-time firefighter-paramedics-EMTs**, an increase of seven from the 2016 staffing levels.



Provides law enforcement services to approximately **17,500 households** and almost **800 businesses**



Provides safety services to more than **44,000** township residents and through a contract, to 2,600 Newtown residents



Contracts for **35 sheriff's officers** to cover 31.2 square miles, including specialized services in schools, traffic, community safety and drug interdiction.



Provides coverage to adjoining **state highways** and **16 miles** of the Little Miami and Ohio rivers

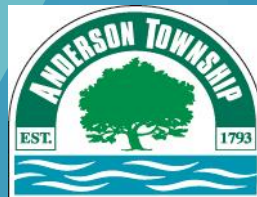

ATFD Responses by Year

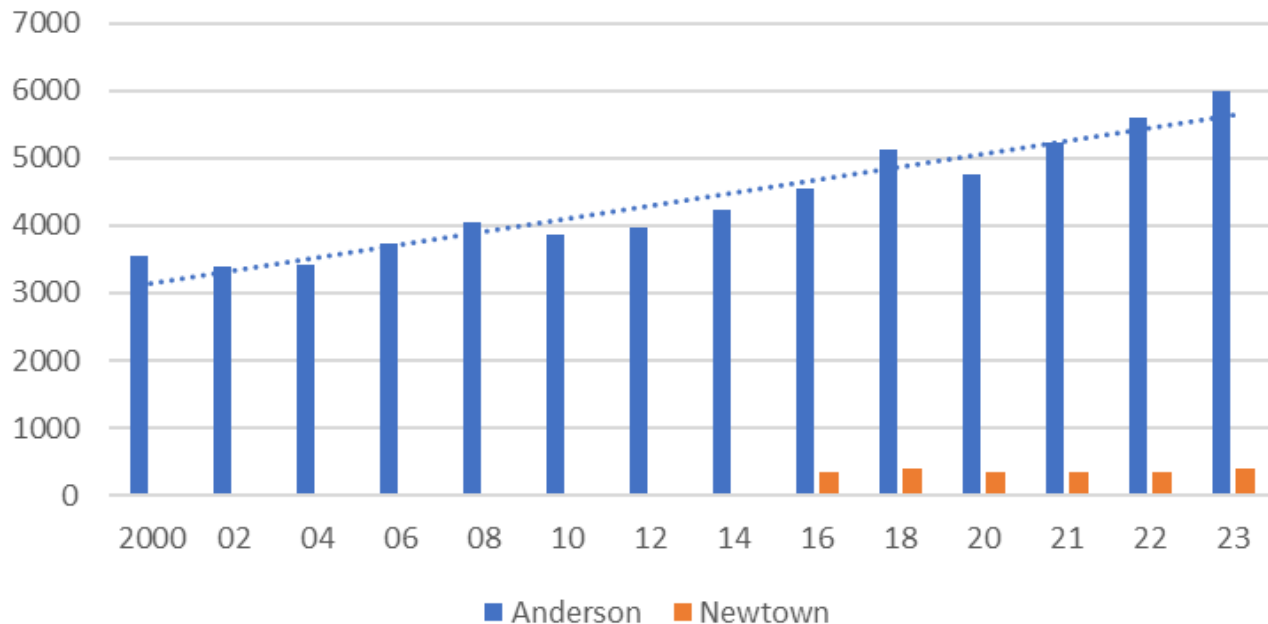

2023 Overall Survival Rate for Non-Traumatic Cardiac Events

<i>Anderson Township Fire & Rescue</i>	22.60%
Ohio	11.90%
National	10.20%

Fire & Rescue Responses 2000 - 2023

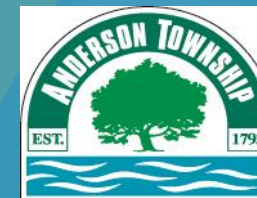

Hamilton County Communication Center

Total Dispatches - Sheriff's Office District 5

Anderson Township, Ohio

2016	15,963
2017	16,494
2018	16,307
2019	16,005
2020	14,474
2021	14,710
2022	15,259
2023	15,530

Most Common Calls

to the Hamilton County Communications Center (911)

2016 - 2023 Averages

Sick / Injured Person	15.8%
Alarm	12.9%
Automobile Accident	7.6%
Report	6.6%
Suspicious Person / Vehicle	4.8%
Domestic Trouble	2.2%
Disabled Vehicle	2.0%
Check on Well Being	1.8%
Trouble / Trouble Brewing	1.7%
Lock Out Assist	1.6%
Psychiatric Emergency	1.3%
Debris in the Road	1.3%

Hamilton Co. Sheriff's District 5 - 911 Dispatches

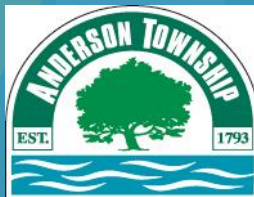

What Is the Status of Anderson Township's Budget?

▶ Safety Services - Fire & Rescue and Sheriff's Services

- ▶ Currently in year eight of a projected five-year levy adopted in 2016, which followed eight-year adoption cycles dating back to 2000-2008
- ▶ **Effective millage is now 64%** of the voted levy approved in 2016 and continues to decline sharply as reappraisals occur

▶ TIF (Capital Projects and Equipment)

- ▶ Tax Increment Financing (TIF) revenues are derived from new growth and development
- ▶ Very healthy and growing fund balance, which has stretched public safety levy through purchase of **fire engines, ambulances, police cruisers, heart monitors, patient cots, traffic signal battery back-up units, turnout gear, radios, Lucas devices (uninterrupted chest compression devices), mechanic tools, etc.**



Public Safety Services



What is the Financial Impact of New Development on Public Safety Services?

- ▶ Most new development in the Township generates either TIF revenue or no revenue, in the case of exempt properties.
- ▶ Overall increase in demand for services with levy revenue remaining flat.
- ▶ Health care facilities utilize public safety services but generate no real estate tax or income tax revenue for the Township.
- ▶ The use of TIF revenue is restricted and cannot be used for expenses such as salaries and benefits or fuel and supplies.

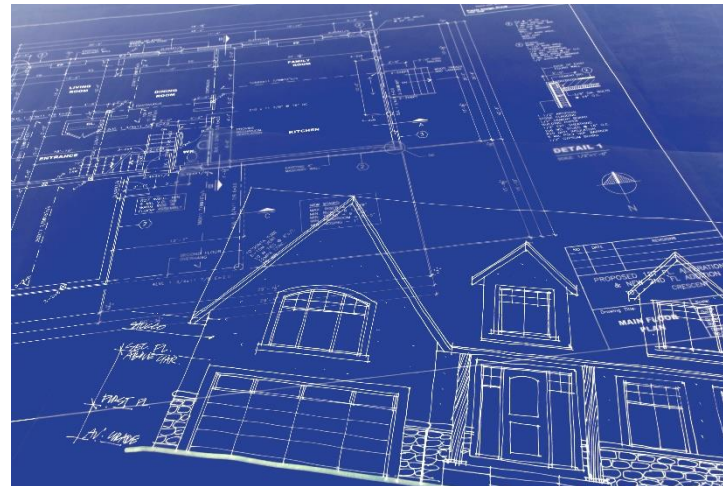

Public Safety Grants & FEMA Reimbursements

Over \$1.8 million received since 2003



Self-Contained Breathing Units

- Respiratory personal protective gear
- Shields firefighters from the effects of smoke and hazardous chemicals
- **\$347,500** FEMA grant provided funding for 52 units



Lucas Devices

- ▶ External chest compression machine
- ▶ Provides uninterrupted, consistent, deep chest compressions on sudden cardiac arrest victims
- ▶ **\$40,000** Ohio Bureau of Workers' Compensation grant provided funding for 4 devices

State Mandated Reduction Factors

- ▶ Ohio Law passed in 1976 (H.B. 920)
 - ▶ Largely enacted to limit the impact of inflation on property tax bills
 - ▶ Department of Taxation recalculates effective tax rates annually, applying reduction factors which eliminate the effect of certain value changes on existing real property
 - ▶ As values increase due to reappraisal, effective tax rate decreases
 - ▶ New levy necessary to generate additional property tax revenue
 - ▶ Inflation increases the taxing authority's expenses

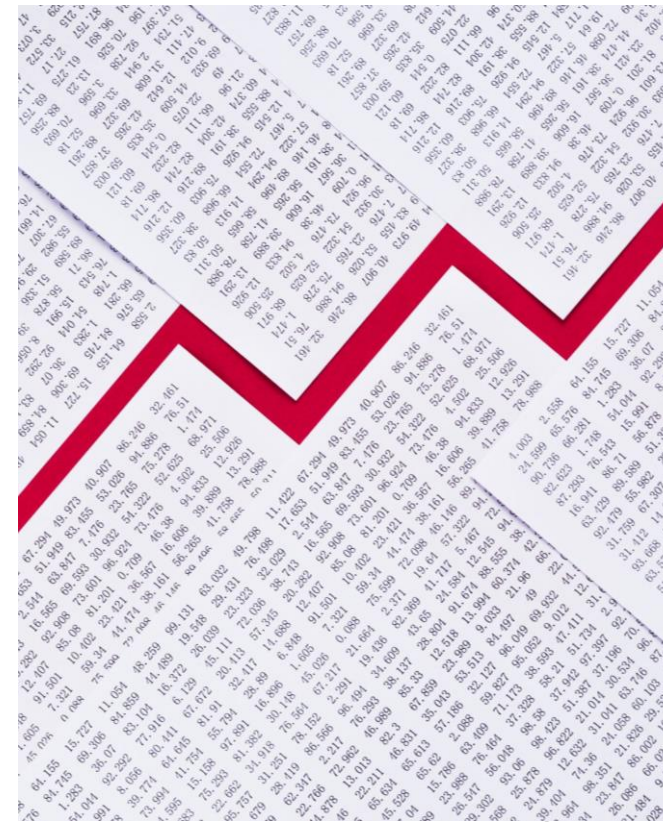

Public Safety Historical Operating Revenue & Expenditures

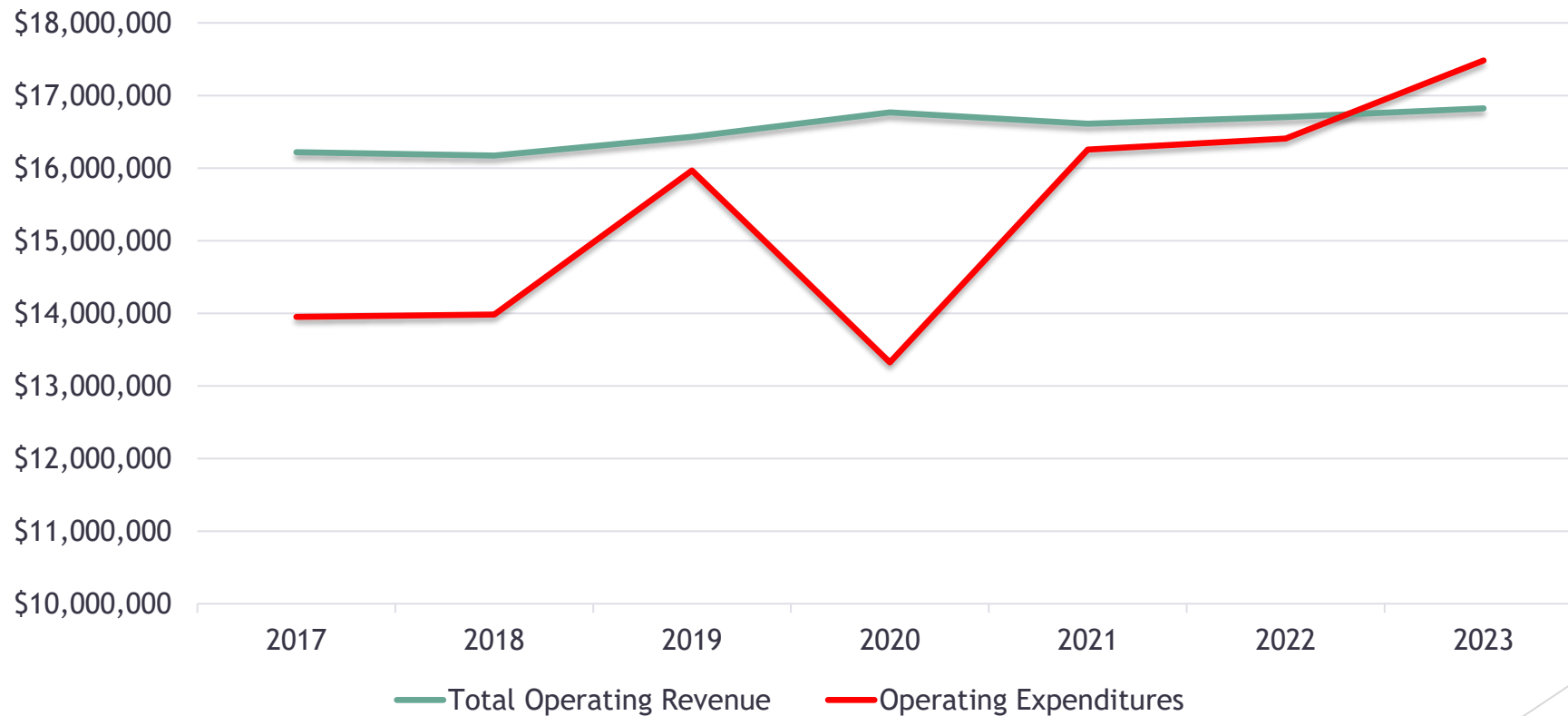

Public Safety Projections Operating Revenue & Expenditures

■ Total Operating Revenue ■ Total Operating Expenditures

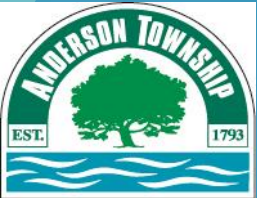
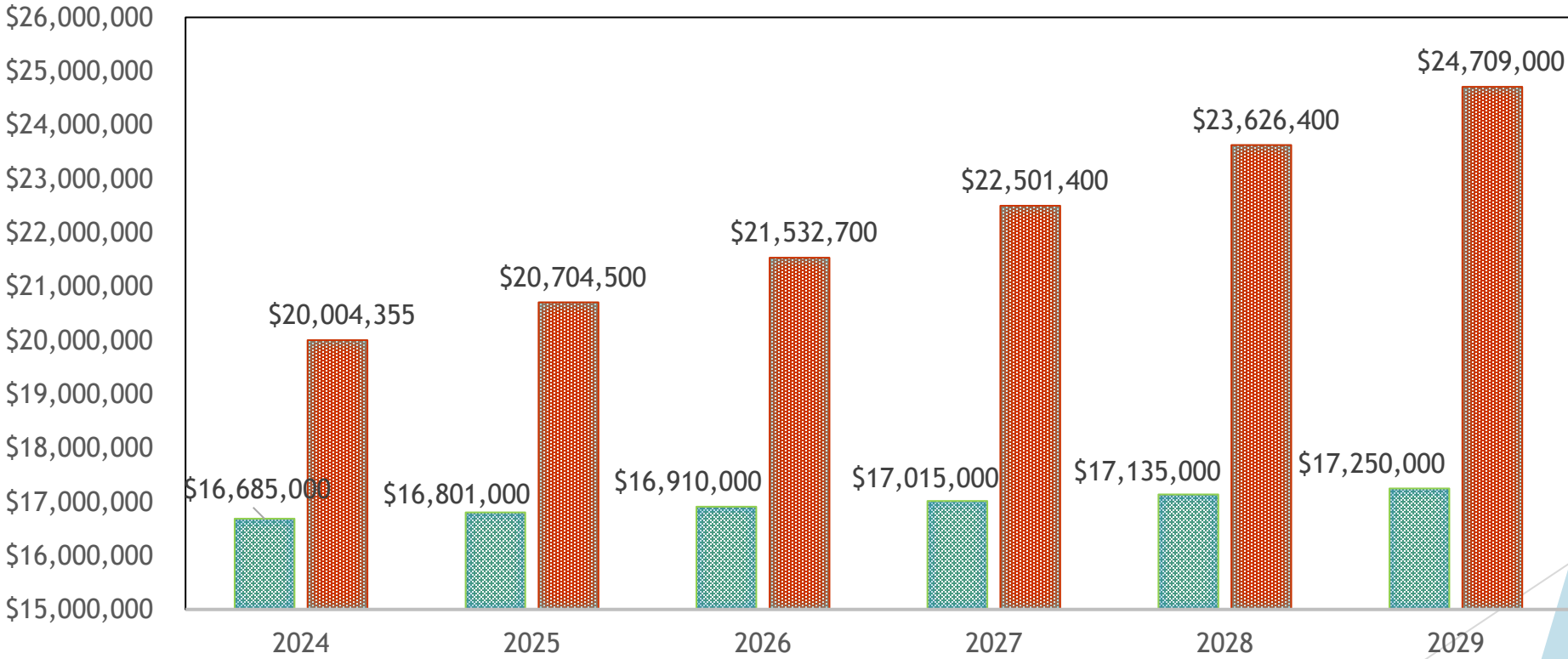

Public Safety Projections Including Additional Levy Revenue Estimates

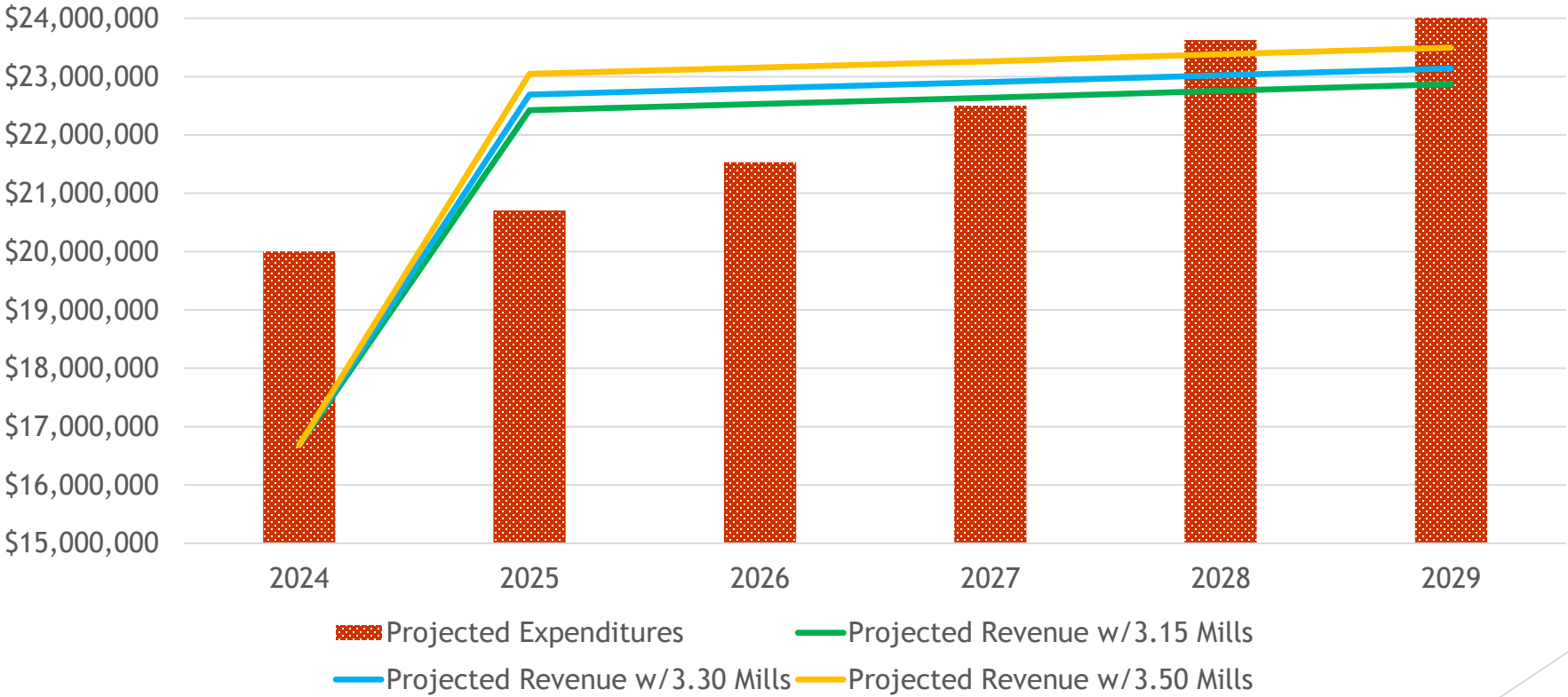



Public Safety Services

